

Iron Turtle Design

A small workshop in Placitas NM USA

IronTurtle@ironturtledesign.com www.ironturtledesign.com

JeriPole Fishing Adapter Kit

For your safety, read and understand the following warnings, cautions and legal disclaimers:

Fishing, hiking, and related activities have inherent risks, dangers, and hazards which cannot be eliminated, particularly in a wilderness setting. Potential hazards include, but are not limited to: hiking on uneven terrain, inclement weather and temperature extremes, water hazards in lakes and rivers including drowning, encounters with flora and fauna, and other humans.

Any person using our equipment in any manner assumes all risks and accepts complete and full responsibility for being knowledgeable of, and prepared for, the environment, conditions, and activity in which they are entering. Any and all damages or injuries of any kind from the use of any of Iron Turtle Designs' equipment are the sole responsibility of the user.

Use of your trekking pole for fishing may void your trekking pole warranty. Contact your trekking pole manufacturer for specific warranty details.

Trekking poles are not indestructible. If your poles show the slightest sign of cracking, do not continue using them in any way, including fishing or hiking.

Maximum fishing line breakage test strength is 6lbs.
Recommended fishing line breakage test strength is 4lbs.
Stresses above maximum line test strength increase the risk of damaging your trekking poles.

Do not hike with the JeriPole pole tip adapter attached to the trekking pole. The pole tip adapter is not intended to withstand trail impacts. After being used for fishing, the pole tip adapter should be removed and replaced with an accessory such as a mud basket, which also serves as a thread protector.

⚠ WARNING: This product can expose you to chemicals which are known to the State of California to cause cancer and birth defects or other reproductive harm.
For more information go to www.P65Warnings.ca.gov.

The JeriPole adapter kit includes:



Flexible rod extension
Pole tip adapter
Line guide
Fly Reel mount
Spinning/Underspin reel mount

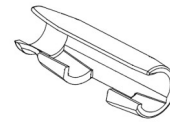
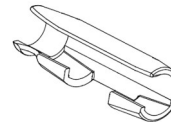

- 1) Clean trekking pole tip threads and attach the pole tip adapter.
- 2) Extend trekking pole lower tip section and lock in place. Do not extend pole beyond the 'stop' mark.
- 3) Remove trekking pole upper handle section from middle section. The handle section is not used.
- 4) Insert flexible rod extension into pole tip adapter.
- 5) Snap on Line Guide to trekking pole middle section.
- 6) Place reel foot into Reel mount socket and snap onto trekking pole middle section.
- 7) Align reel and eyelets for smooth fishing line travel.

Correct JeriPole assembly shown:

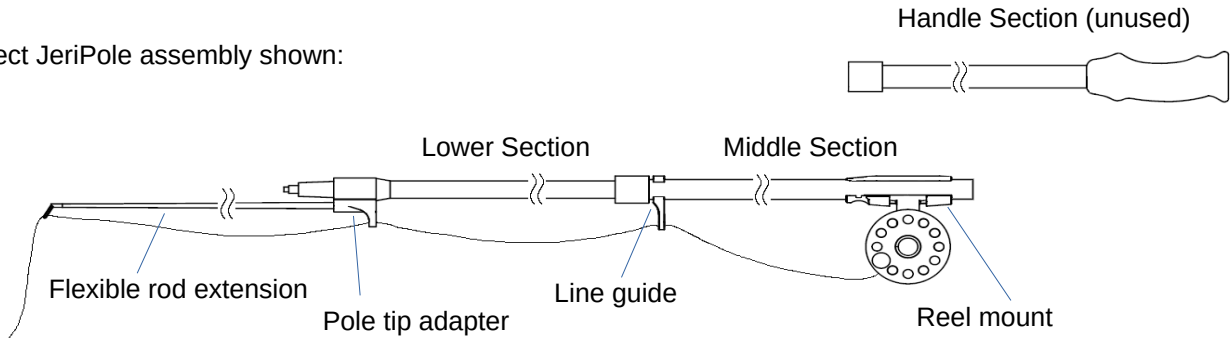

When done fishing, remove the JeriPole components and reassemble your trekking pole.
Confirm the pole locks are secured according to your pole manufacturer's instructions.

While hiking, the flexible rod extension can be stowed inside the trekking pole middle section.

